

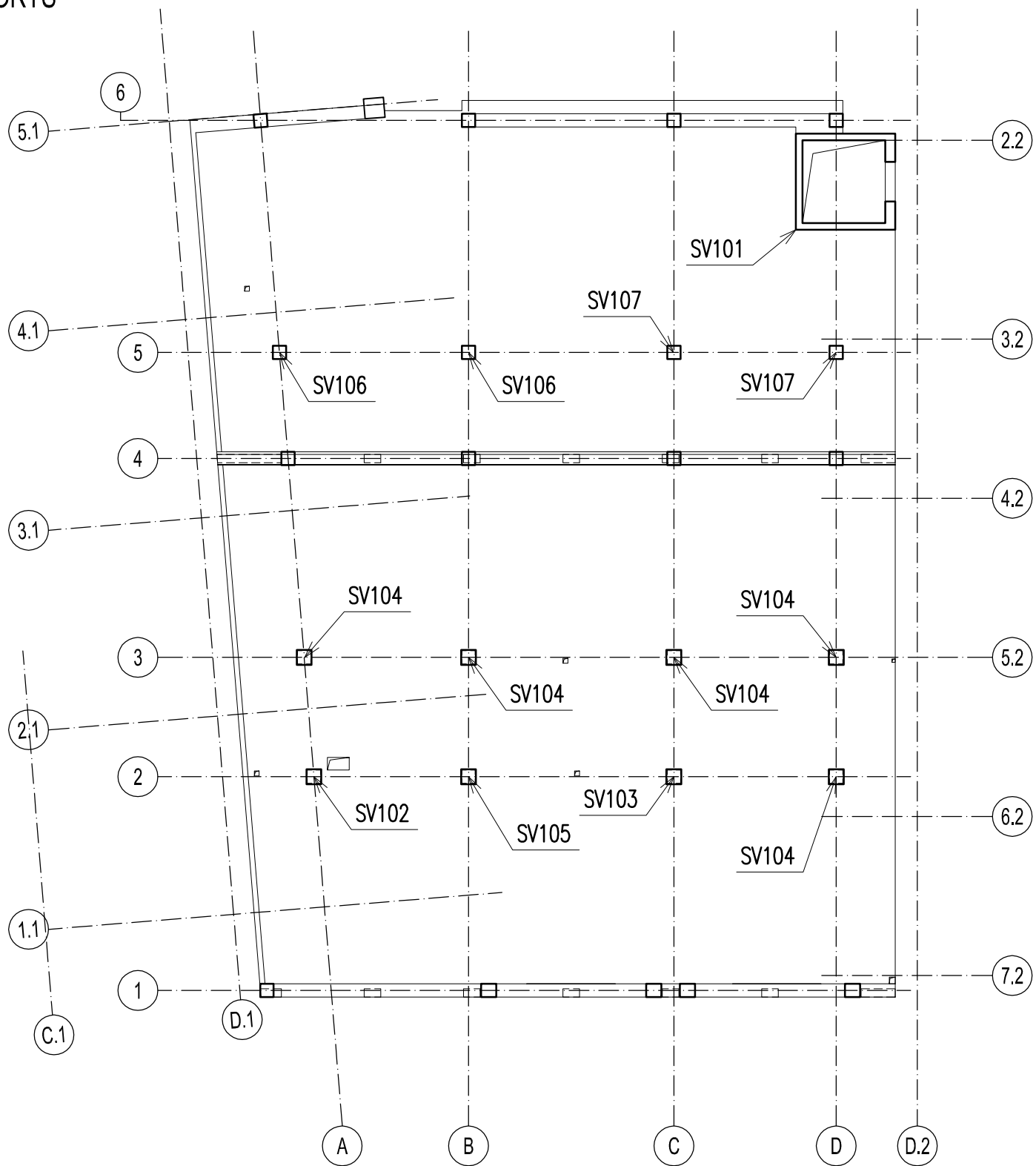

$\pm 0,000 = 209,450 \text{ m n.m.}$

VED.PROJEKTU:	ZODPOVĚDNÝ PROJEKTATNT ČÁSTI:	KRESLIL:	MIX MAX–ENERGETIKA, s.r.o. Štefánikova 38a 612 00 Brno–Královo Pole	
Ing. Tomáš Vymětal	Ing. Pavel Hladík	Ing. Martin Přikryl		
INVESTOR:	Integrovaná střední škola, Slavkov u Brna, Tyršova 479			
STAVBA:	DOSTAVBA UČEBEN - ISŠ SLAVKOV U BRNA		FORMÁT:	A4
OBJEKT:			DATUM:	01/2017
			STUPEŇ:	DPS
			ČÍSLO ZAKÁZKY:	
NÁZEV VÝKRESU:			STROPNÍ DESKA NAD 1.NP - SMYKOVÁ VÝZTUŽ	
	1:50	D.1.2.24		

STROPNÍ DESKA NAD 1.NP - OZNAČENÍ SMYKOVÉ VÝZTUŽE

PŮDORYS



	ISŠ Slavkov	Strana: ...
	SV101	List: 1

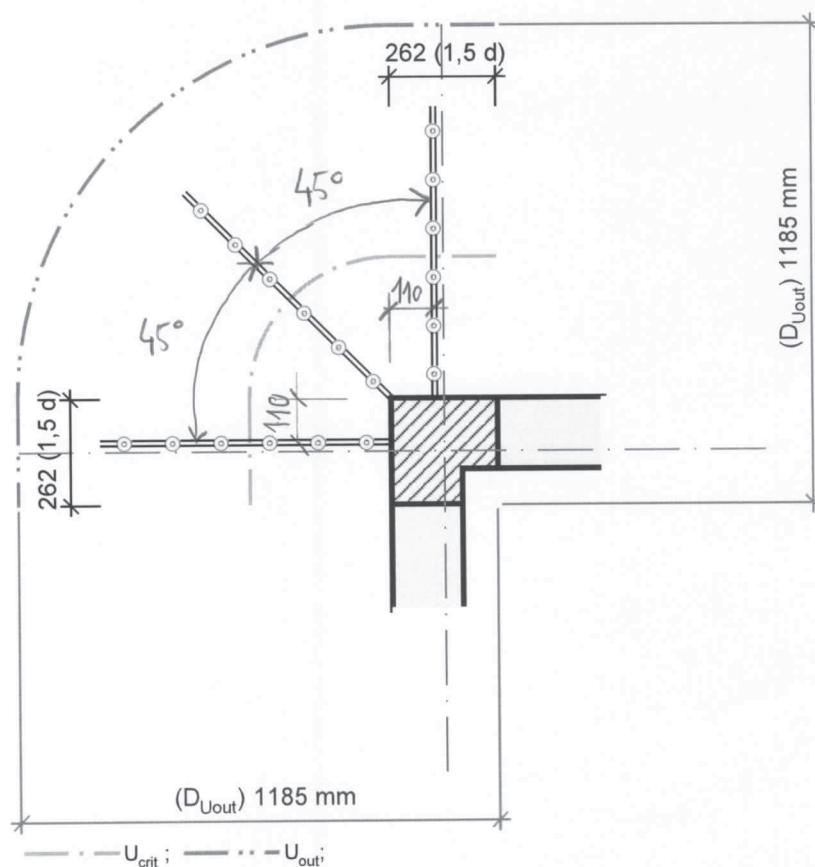

3x Schöck BOLE 12/170-6/A720-CV25

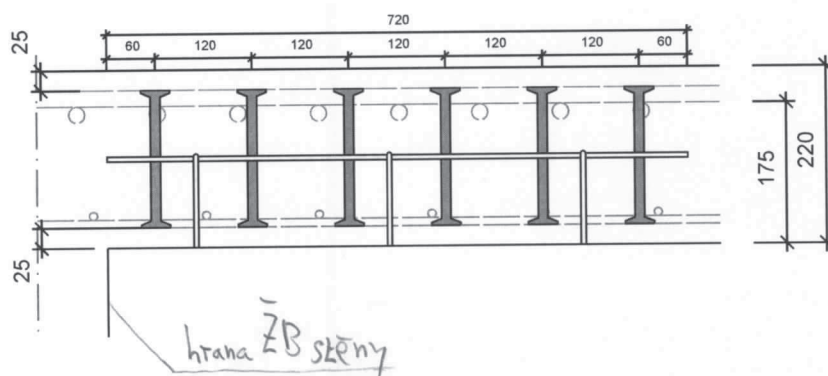

	ISŠ Slavkov	Strana: ...
	SV103	List: 1

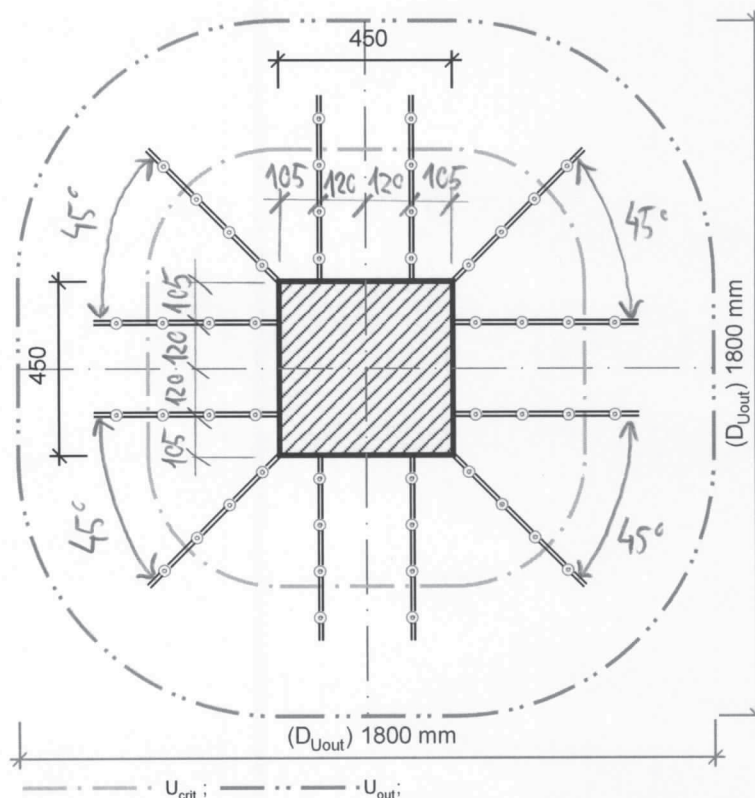

12x Schöck BOLE 10/170-4/A480-CV25

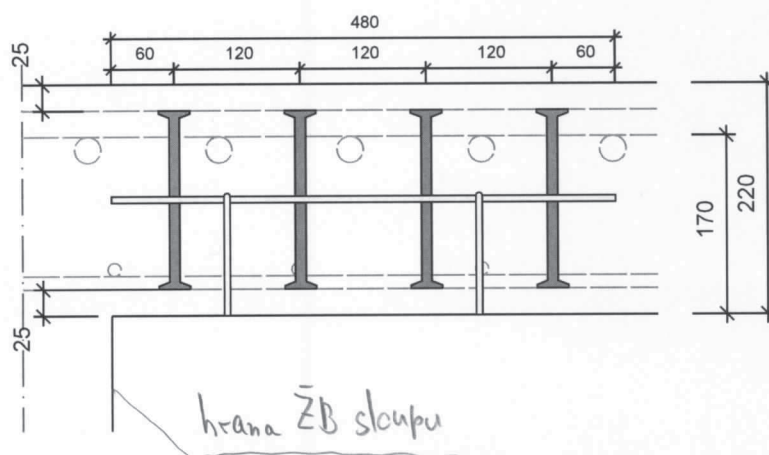

	ISŠ Slavkov	Strana: ...
	SV104	List: 1

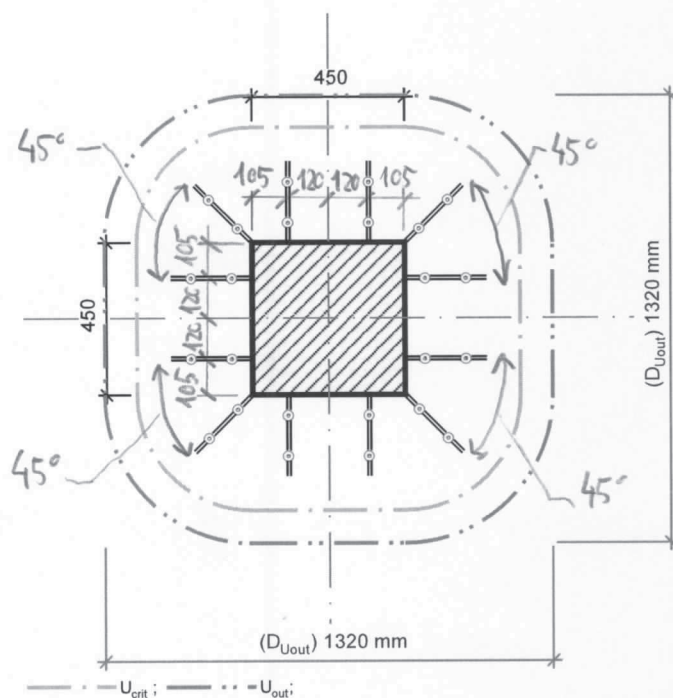

12x Schöck BOLE 10/170-2/A240-CV25

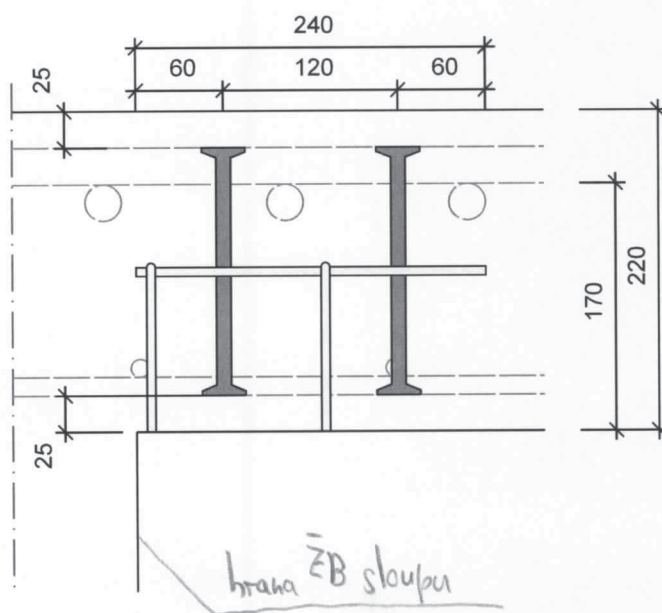

	ISŠ Slavkov	Strana: ...
	SV105	List: 1

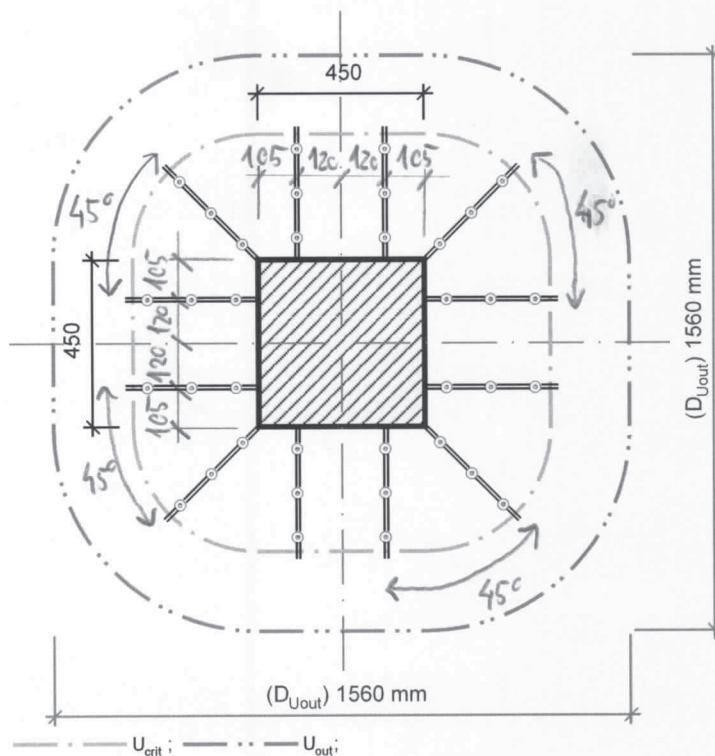

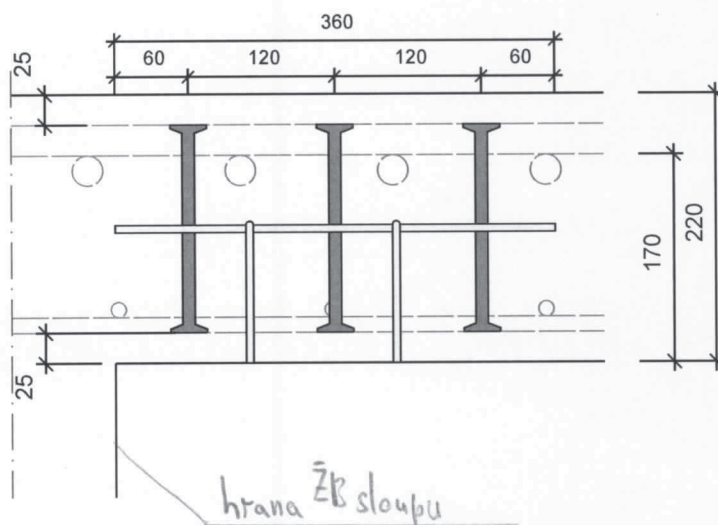

12x Schöck BOLE 10/170-3/A360-CV25

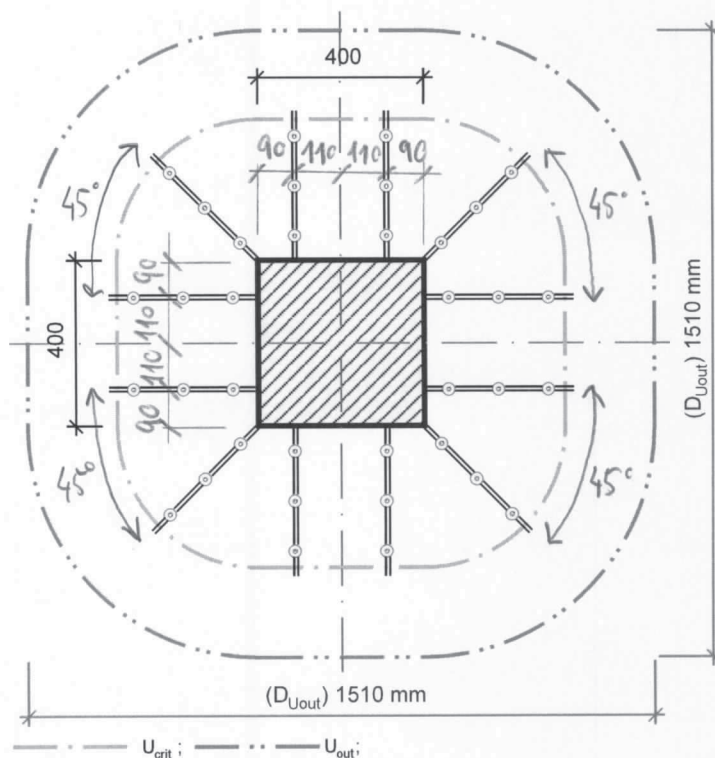

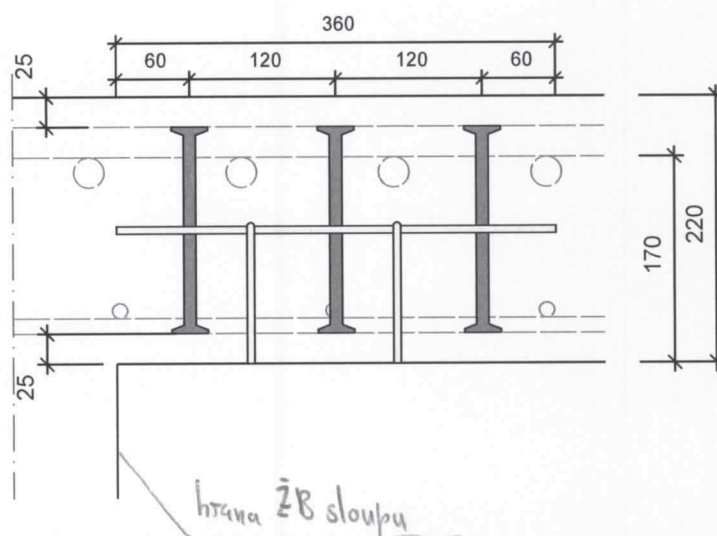

12x Schöck BOLE 10/170-3/A360-CV25



	ISŠ Slavkov	Strana: ...
	SV107	List: 1

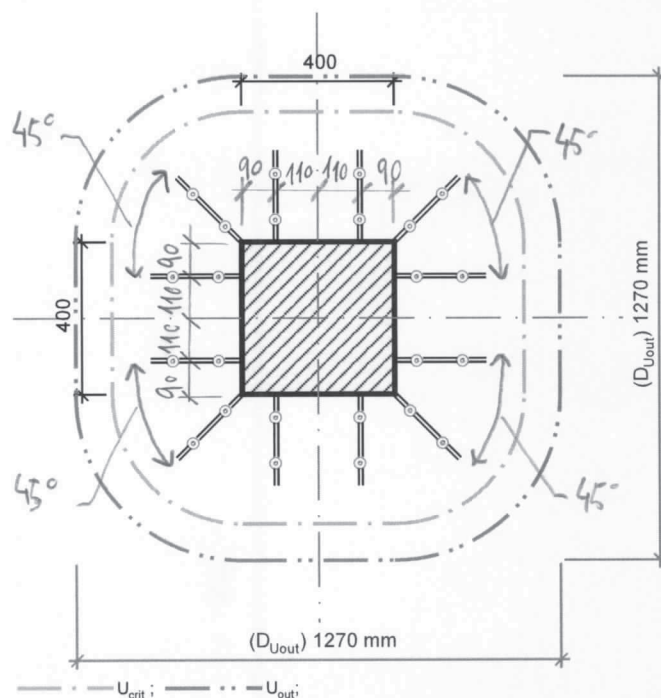

12x Schöck BOLE 10/170-2/A240-CV25

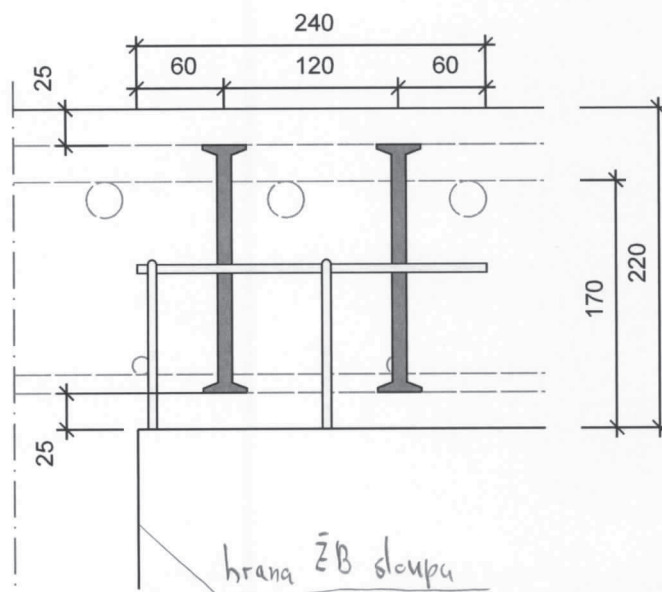

VÝPIS SPECIÁLNÍCH PRVKŮ:

STROPNÍ DESKA NAD 1.NP

Schöck BOLE 12/170-6/A720-CV25	– 3 ks
Schöck BOLE 10/170-4/A480-CV25	– 23 ks
Schöck BOLE 10/170-2/A240-CV25	– 84 ks
Schöck BOLE 10/170-3/A360-CV25	– 36 ks

– UVEDENÉ TRMÍNKOVÉ LIŠTY MOHOU BÝT NAHRAZENY PRVKY JINÉHO VÝROBCE SE STEJNÝMI VLASTNOSTMI.